

National Museum of Ethnology , Osaka, Japan (MINPAKU)



Deputy Director-General

Katsumi TAMURA

History of National Museum of Ethnology

- established in 1974

to conduct anthropological and ethnological research and aims to promote a general understanding and awareness of peoples, societies and cultures around the world through the collection and conservation of ethnographic materials and public exhibitions.

Inter- University Research Institute

- 2004 re-start as an Inter- University

Research Institute

to promote its own research as well as joint research with other members of the National Institutes for the Humanities, comprehensively addressing the study of human cultures.

staff

Staff

as of October 1, 2009

Category	Director- General	Prof.	Assoc. Prof.	Assist. Prof.	Subtotal	Clerical staff (including technical staff)	Total
Staff	1	28	27	3	59	44	103
Japanese Cooperating Faculty		15	4		19		19
Overseas Visiting Faculty		4	2		6		6
Director-General	1				1		1
Office of Administration						26	26
Office of Information and Documentation						17	17
Research Departments		20	18	1	39		39
Center for Research Development		3	3	1	7		7
Research Center for Cultural Resources		5	6	1	12		12

Note: Visiting faculty members are not included in the numbers given for "Staff" members.

Budget

Budget

2008	(millions of yen)
<hr/>	
Category	
<hr/>	
Salaries	1,326
Others	1,998
Education and research	1,208
General management costs	767
Facilities	23
<hr/>	
Total	3,324
<hr/>	

Note: These figures are from the revised budget.

2009	(millions of yen)
<hr/>	
Category	
<hr/>	
Salaries	1,306
Others	1,693
Education and research	1,122
General management costs	571
Facilities	0
<hr/>	
Total	2,990
<hr/>	

Note: These figures are from the annual budget.

The Basic Concept of the Museum Desian



Total area of grounds: 40,821 m²
Ground area occupied by the museum
buildings: 17,089 m²
Total floor space: 51,225 m²

Basement 3,015 m²

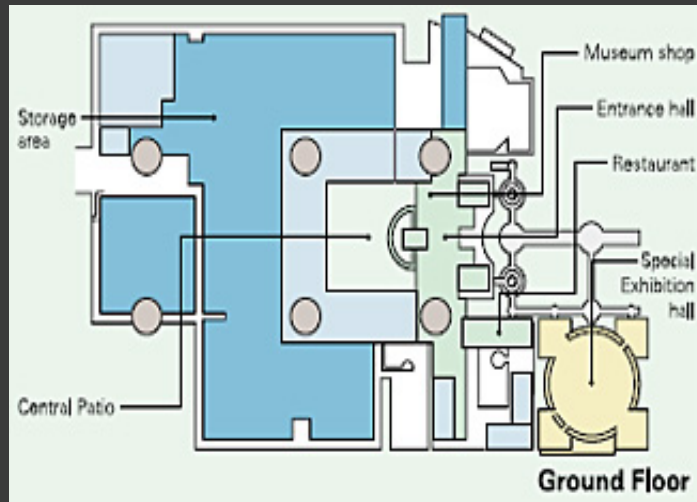

Ground Floor 15,987 m²

Entrance hall, central patio, restaurant, Special Exhibition hall, storage area and museum shop.

Second Floor 16,830 m²

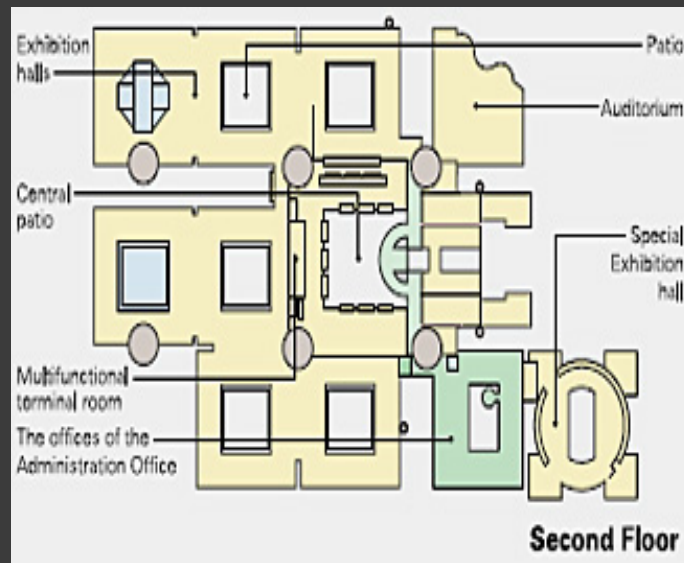

Exhibition halls, patio, central patio, multifunctional terminal room, the offices of the Administration Office, Special Exhibition hall and auditorium (seating capacity for 462 persons).

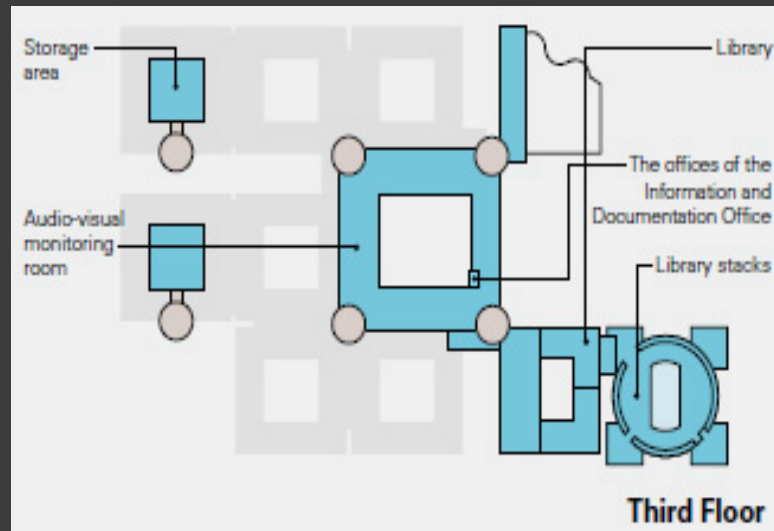

Third Floor 7,340 m²

The offices of the Information and Documentation Office, library, library stacks, audio-visual monitoring room and storage areas.

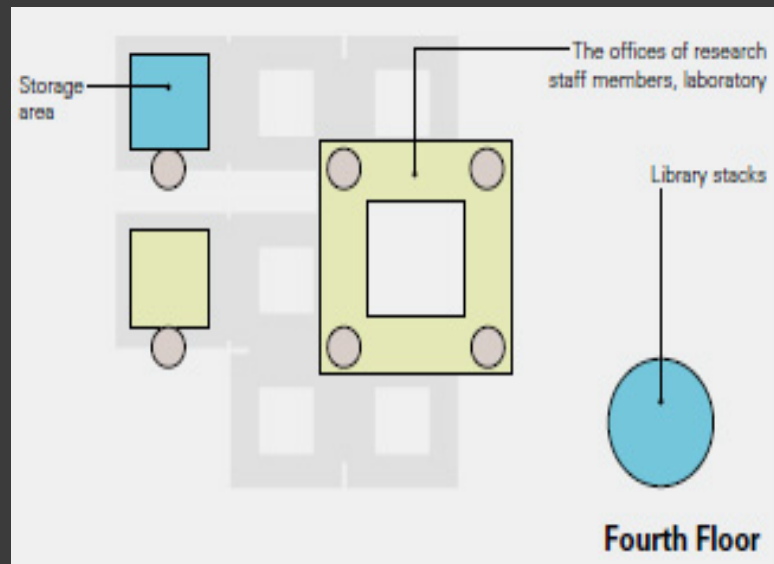

Fourth Floor 7,207 m²

The offices of research staff members, laboratories, library stacks, and storage area.

Rooftop 846 m²

Functions

research institute

joint
research

information
center

exhibitions

social
contributions

graduate
program

research institute

- The Museum functions as a research institute equipped with a museum. It serves as a research center for anthropology and ethnology, providing information and research results to academic communities and the general public through publications and a variety of other forms.

joint research

- As an Inter-University Research Institute, the Museum supports and organizes joint research projects with a number of researchers from other academic institutions. Research materials collected and stored in the Museum are widely used by those researchers.

information center

- The Museum has collected and maintained ethnological research materials over the years, including artifacts, audio-visual materials, books and other forms of research data. It is also a repository for the HRAF (Human Relations Area Files). Information about these materials is provided to researchers inside and outside the Museum through computerized databases.

exhibitions

- The research results of the Museum are open to the public through exhibitions.

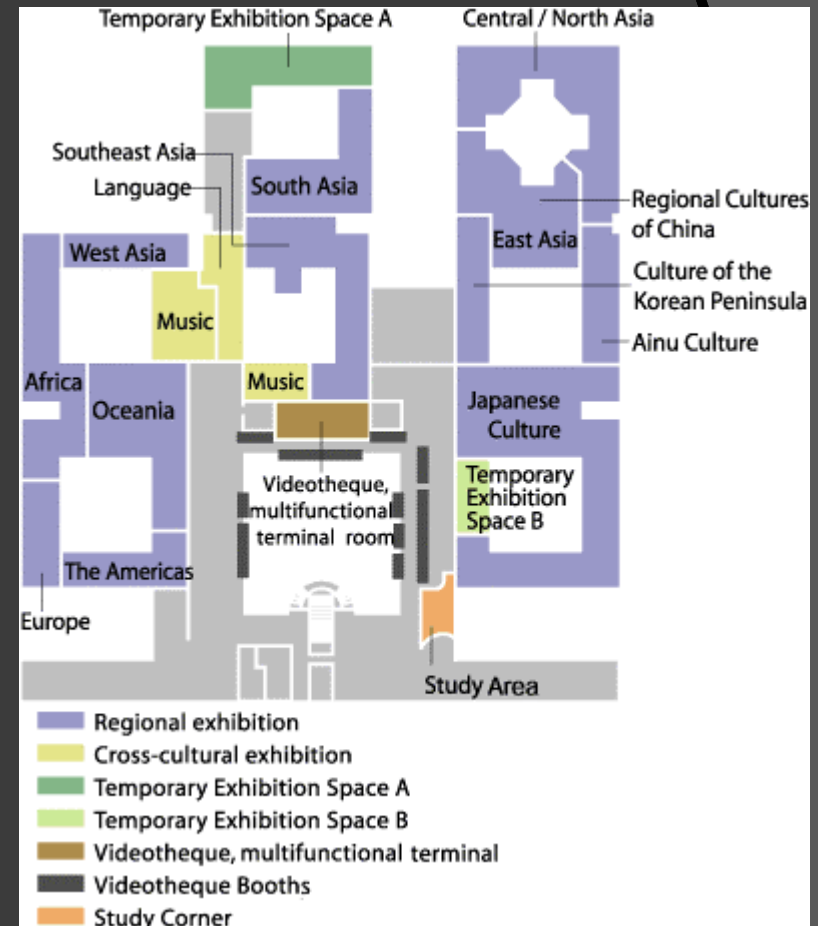



The Museum presents temporary, comprehensive exhibitions on special topics to make its joint research available to the public.

Thematic Exhibitions are also held from time to time which focus on rapidly changing world situations and feature current research in cultural anthropology and ethnology.





第1回 田村 克己 教授
東南アジアの30年
2007年4月28日(土)



第16回 劉 明基 客員教授
韓国の老人問題
2007年6月23日(土)



第57回 太田 心平 助教
キリスト教でひもとく現代韓国
2008年3月2日(日)



graduate program

- The School of Cultural and Social Studies of the Graduate University for Advanced Studies, based at the Inter-University Research Institute, is located at the Museum. It has two courses: Local Cultural Studies and Comparative Cultural Studies. These Departments offer research training programs leading to the Ph.D. degree with the aim of producing unique professional scholars.

